

➔ **VIIP-10** [VIIP-10W · VIIP-10E · VIIP-10D]

10.1" colour touch-screen with SIP video intercom support

Installation controlling and monitoring with SIP video intercom devices support and call forwarding for Smartphones and Tablets.



- 10.1" LCD colour capacitive touch-screen
- Resolution 1024 x 600px
- Full control of all elements of an installation by rooms or plans view
- Executes anual timed events
- Control of technical alarms and intrusion by screen with icons and messages, by email, or by push notifications to mobile devices
- Compatibility with Google Home for voice control
- Includes real presence simulation
- Automatic software updates by Internet
- Mounted on universal box, screwed on wall
- Available in black or white finish
- Size: 276 x 182 x 2mm (25 depth)



Description

The VIIP-10 is a 10.1" colour capacitive touch interface to control and monitor a BUSing® installation using 3D plans and/or photographs, with alluding icons, custom panels, etc.

It has an integrated web server that allows to control the installation via the Internet using a web browser or through the official Ingenium Apps available for Google Android and Apple iOS. It is also Google Home compatible.

This display has WiFi and Ethernet connectivity (depending on the model) that allows upgrade to the latest software available or control the installation from the cloud via Smartphone or Tablet.

Configuration using Development System (SIDE)

- Supports up to 100 control plans.
- Program up to 100 scheduled scenes.
- Armed and disarmed intruder alarm with password (4 digits).
- Technical alarm alerts using icons and screen messages, e-mail messages or push notifications to mobile devices.

Technical Characteristics

Device Reference	Voltage Supply	Current Consumption	Screen Resolution
VIIP-10	9-16V DC (BUS)	725mA (BUS)	1024 x 600px

➔ **VIIP-10**

Installation



Use the metal wall bracket included screwing it to wall and/or flush-mounted universal box, hanging the device on the 4 slots located in the rear.

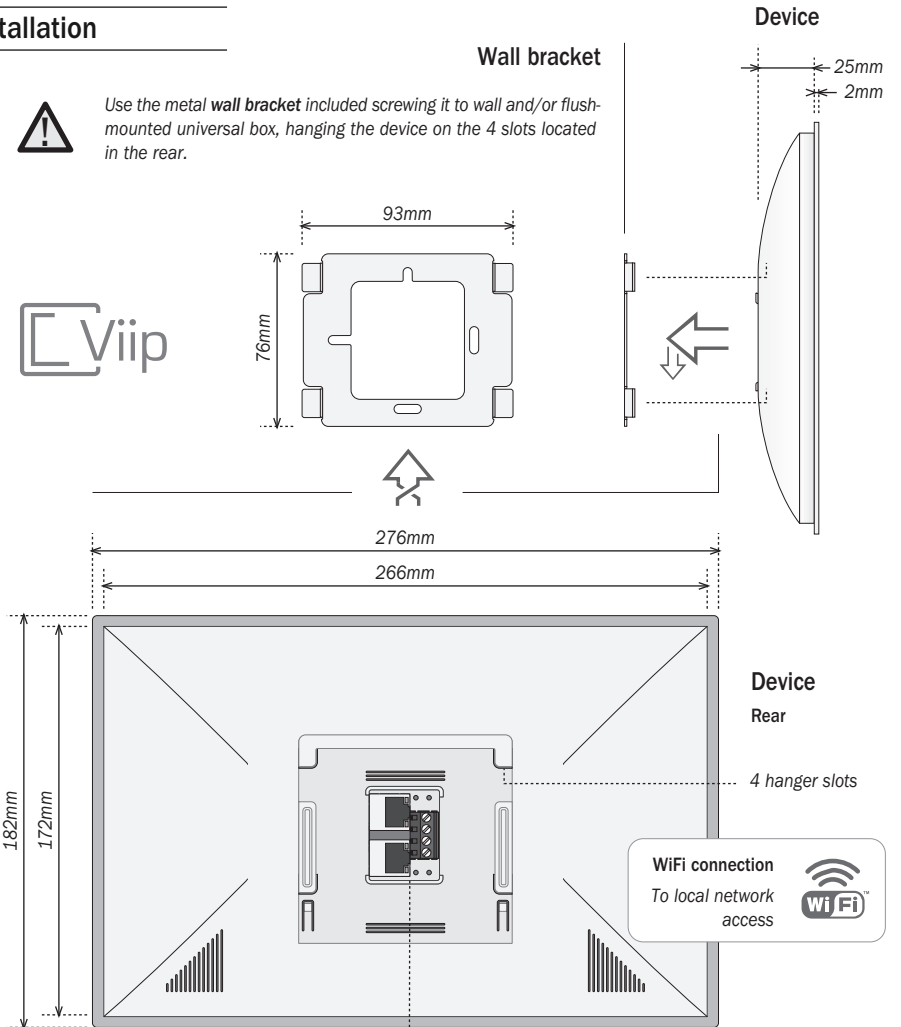

3 network interface options (depending on model)

